

IS : 12023 - 1987

*Indian Standard*

CODE OF PRACTICE FOR  
FIELD MONITORING OF MOVEMENT OF  
STRUCTURES USING TAPE EXTENSOMETER

UDC 624.620.172.2.087.45 : 006.76

© Copyright 1987

**BUREAU OF INDIAN STANDARDS**  
MANAK BHAVAN, 9 BAHADUR SHAH ZAFAR MARG  
NEW DELHI 110002

# Indian Standard

## CODE OF PRACTICE FOR FIELD MONITORING OF MOVEMENT OF STRUCTURES USING TAPE EXTENSOMETER

Foundation Engineering Sectional Committee, BDC 43

<i>Chairman</i>	<i>Representing</i>
MAJ GEN OMBIR SINGH	Ministry of Defence
<i>Members</i>	
COL K. P. ANAND ( <i>Alternate to</i> Maj Gen Ombir Singh )	
ADDITIONAL DIRECTOR ( GE )	Ministry of Railways, RDSO
ADDITIONAL DIRECTOR (S) ( <i>Alternate</i> )	
SHRI K. K. AGGARWAL	Posts and Telegraph Department, New Delhi
SHRI B. ANJIAH	A. P. Engineering Research Laboratories, Hyderabad
SHRI ARJUN RIJHSINGHANI	Cement Corporation of India, New Delhi
SHRI O. S. SRIVASTAVA ( <i>Alternate</i> )	
DR R. K. BHANDARI	Central Building Research Institute ( CSIR ), Roorkee
SHRI CHANDRA PRAKASH ( <i>Alternate</i> )	
SHRI MAHABIR BIDASARIA	Ferro-Concrete Consultants Pvt Ltd, Indore
SHRI ASHOK BIDASARIA ( <i>Alternate</i> )	
SHRI S. P. CHAKRABARTI	Ministry of Transport ( Roads Wing ), New Delhi
SHRI P. K. DATTA ( <i>Alternate</i> )	
SHRI A. K. CHATTERJEE	Gammon India Ltd, Bombay
SHRI A. C. ROY ( <i>Alternate</i> )	
CHIEF ENGINEER	Calcutta Port Trust, Calcutta
SHRI S. GUHA ( <i>Alternate</i> )	
SHRI R. K. DAS GUPTA	Simplex Concrete Piles ( I ) Pvt Ltd, Calcutta
SHRI H. GUHA BISWAS ( <i>Alternate</i> )	
SHRI A. G. DASTIDAR	In personal capacity ( 5 Hungerford Court, 121, Hungerford Street, Calcutta )
SHRI V. C. DESHPANDE	Pressure Piling Co (I) Pvt Ltd, Bombay
DIRECTOR ( CSMRS )	Central Soil and Materials Research Station, New Delhi
CHIEF RESEARCH OFFICER ( CSMRS ) ( <i>Alternate</i> )	

( Continued on page 2 )

© Copyright 1987

BUREAU OF INDIAN STANDARDS

This publication is protected under the *Indian Copyright Act* ( XIV of 1957 ) and reproduction in whole or in part by any means except with written permission of the publisher shall be deemed to be an infringement of copyright under the said Act.

( Continued from page 1 )

*Members*

SHRI A. H. DIVANJI  
 SHRI A. N. JANGLE ( *Alternate* )  
 SHRI A. GHOSHAL  
 DR GOPAL RANJAN  
 SHRI N. JAGANNATH  
 SHRI A. K. MITRA ( *Alternate* )  
 SHRI ASHOK K. JAIN  
 SHRI VIJAY KUMAR JAIN ( *Alternate* )  
 JOINT DIRECTOR ( DESIGN )  
 SHRI SUNIL BERY ( *Alternate* )  
 DR R. K. KATTI  
 SHRI S. R. KULKARNI  
 SHRI S. ROY ( *Alternate* )  
 SHRI A. P. MATHUR  
 SHRI V. B. MATHUR  
 SHRI S. MUKHERJEE  
 SHRI T. K. D. MUNSI  
 SHRI M. IYENGAR ( *Alternate* )  
 SHRI A. V. S. R. MURTY  
 SHRI B. K. PANTHAKY  
 SHRI V. M. MADGE ( *Alternate* )  
 SHRI M. R. PUNJA  
 SHRI O. J. KETKAR ( *Alternate* )  
 DR V. V. S. RAO  
 DR A. SARGUNAN  
 SHRI S. BOMMINATHAN ( *Alternate* )  
 SUPERINTENDING ENGINEER  
 ( DESIGNS )  
 EXECUTIVE ENGINEER  
 ( DESIGNS V ) ( *Alternate* )  
 DR A. VARADARAJAN  
 DR R. KANIRAJ ( *Alternate* )  
 SHRI G. RAMAN,  
 Director ( Civ Engg )

*Representing*

Asia Foundations and Construction Private Limited, Bombay  
 Stup Consultants Limited, Bombay  
 University of Roorkee, Roorkee  
 Steel Authority of India Ltd, Durgapur  
 G. S. Jain & Associates, New Delhi  
 National Buildings Organization, New Delhi  
 Indian Institute of Technology, Bombay  
 M. N. Dastur & Company Pvt Ltd, Calcutta  
 Central Warehousing Corporation, New Delhi  
 Mckenzie's Ltd, Bombay  
 In personal capacity ( E-104 A, Simla House, Nepean Sea Road, Bombay )  
 Engineers India Limited, New Delhi  
 Indian Geotechnical Society, New Delhi  
 Hindustan Construction Co Ltd, Bombay  
 Cemindia Company Ltd, Bombay  
 Nagadi Consultants Private Limited, New Delhi  
 College of Engineering, Guindy, Madras  
 Central Public Works Department, New Delhi  
 Indian Institute of Technology, New Delhi  
 Director General, BIS ( *Ex-officio Member* )

*Secretary*

SHRI K. M. MATHUR  
 Joint Director ( Civ Engg ), BIS

( Continued on page 11 )

# *Indian Standard*

## CODE OF PRACTICE FOR FIELD MONITORING OF MOVEMENT OF STRUCTURES USING TAPE EXTENSOMETER

### 0. FOREWORD

**0.1** This Indian Standard was adopted by the Indian Standards Institution on 22 January 1987, after the draft finalized by the Foundation Engineering Sectional Committee had been approved by the Civil Engineering Division Council.

**0.2** One of the instruments which is used for the measurement of movement of structure is tape extensometer. The tape extensometer is capable of measuring changes in distance between two points and, therefore, is utilised for the measurement of movements/deformations/displacements for different structures like slope surface, tunnels, underground power houses, bridges and buildings. This standard has been formulated to give guidance in regard to the field monitoring of various movements of such structures with the help of this instrument including its maintenance.

**0.3** For the purpose of deciding whether a particular requirement of this standard is complied with, the final value, observed or calculated, expressing the result of a test or analysis, shall be rounded off in accordance with IS : 2-1960\*. The number of significant places retained in the rounded off value should be the same as that of the specified value in this standard.

---

### 1. SCOPE

**1.1** This standard covers the details of the installation and monitoring by tape extensometer for observing slope surface movement, radial movement of lining of tunnels, deformations of excavation, and displacement of various structures.

**NOTE** — This instrument is not suitable for continuous recording and monitoring.

---

\*Rules for rounding off numerical values ( *revised* ).

## 2. GENERAL

2.1 The measurements should be made with the help of steel tape which has precision punched holes at regular intervals of 5 cm. The measurement can be made in any direction — vertical, horizontal or inclined. The comparison of the current reading with initial reading should give the measurement of movement. The displacement is measured between pair of identical ball reference studs or hooks grouted into shallow holes in the structure.

2.2 The free end of the tape should be attached to a spring loaded connector which rotates on a ball reference stud/hook. The fixed end of the tape should be fitted to the tape reel fixed in the body which has a ball location assembly/hook identical to that on free end of the steel tape.

2.3 The tape tensioning should be achieved by rotating the knurled section of the instrument after engaging and locking the location pin into appropriate tape hole. The correct tape tension is indicated when the index mark on spring plunger coincides with the index mark in the window.

## 3. EQUIPMENT

### 3.1 Tape Extensometer ( see Fig. 1 )

3.1.1 The measuring range of the instrument shall be between 1 to 30 m in any direction and the accuracy shall be  $\pm 0.1$  mm.

3.1.2 It shall be robust and strong against mechanical damage under field conditions.

3.1.3 The reading time shall be between 2 to 3 minutes.

3.1.4 It shall consist of the following:

- a) Tape extensometer unit ( see Fig. 1A ),
- b) Portable calibration frame ( see Fig. 1B ),
- c) Replaceable steel tape ( see Fig. 1C ),
- d) Replaceable dial gauge ( see Fig. 1D ), and
- e) Tape adopter hook ( see Fig. 1E & 1F ).

3.2 Permanent Reference Studs/Hooks — It shall consist of the following:

- a) Permanent reference Stud Hook ( see Fig. 2A ), and
- b) Protective plug/cap ( see Fig. 2B and 2C ).

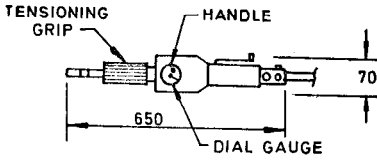

1A TAPE EXTENSOMETER UNIT

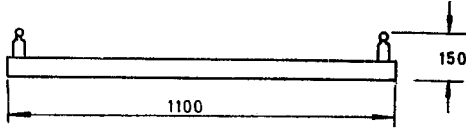

1B PORTABLE CALIBRATION FRAME

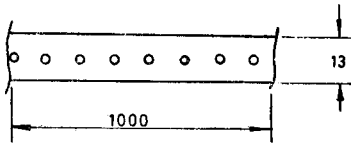

1C REPLACEMENT STEEL TAPE

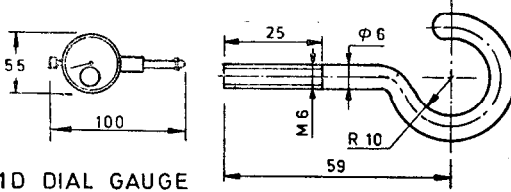

1D DIAL GAUGE

1F TAPE ADAPTOR  
(HOOK)

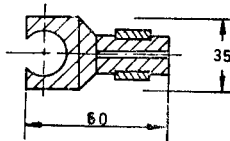

1E TAPE ADAPTOR  
(STUD)

All dimensions in millimetres.  
FIG. 1 TAPE EXTENSOMETER

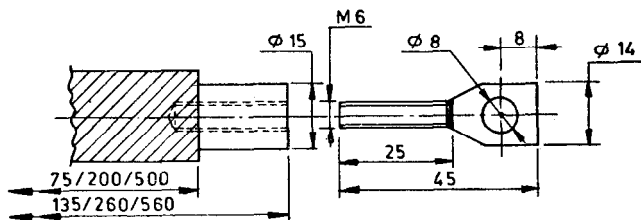

FOR HOOK

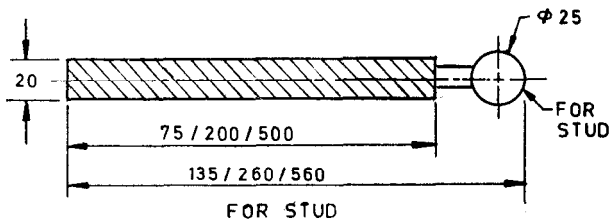

FOR STUD

2A PERMANENT REFERENCE STUD/  
HOOK ANCHOR

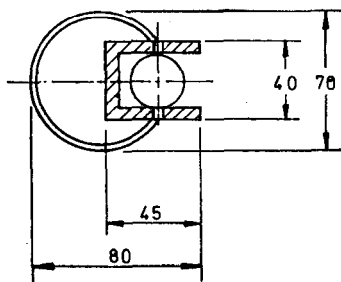

2B PROTECTIVE PLUG

All dimensions in millimetres.

FIG. 2 PERMANENT REFERENCE STUDS — *Contd*

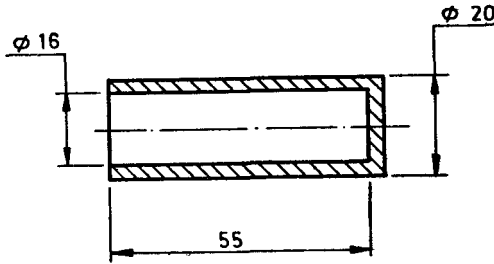

## 2C PROTECTIVE CAP

All dimensions in millimetres.

FIG. 2 PERMANENT REFERENCE STUDS

**3.3 Installation Equipment** — It shall consist of the following:

- a) Resin/cement,
- b) Installation spanner, and
- c) Fixing key.

## 4. CALIBRATION

**4.1** The instrument should be calibrated before and after every set of reading to ensure accurate and reliable results with the help of portable calibration frame ( *see* Fig. 1B ).

## 5. INSTALLATION

**5.1** The reference studs/hooks should be stalled in pre-determined patterns, that is, radially or in a triangular grid for monitoring convergence of the lining ( *see* Fig. 3 ).

**5.2** The anchor length should be selected to suit the nature of the material in which they should be stalled, that is, longer length should be required for monitoring of lining of tunnel shafts while shorter lengths should be required for bridge piers, etc.

**5.3** The anchor should be installed in drill holes of diameters not less than 25 mm and should be fixed with the help of cement or resin grout.

**5.4** The protective plug should be fitted to the anchor before installation to prevent grout entering the threads.

**5.5** In order to take readings the plug should be removed using a special key and is replaced by the reference stud.

## 6. OPERATION

**6.1** The operation of tape extensometer should be done as under.

**6.1.1** Engage the thrust bearing assembly on to the reference stud/hook.



6.1.2 Stretch the free end of the steel tape to the second reference stud/hook.

6.1.3 Engage and lock the pin into the appropriate tape hole.

6.1.4 Achieve the required tension by rotating knurled handle till the index mark on the spring plunger lines up on the window of spring housing.

6.1.5 The reading should be taken by noting the visible pin hole position from the tape at the instrument nose followed by the reading shown in the dial gauge ( see Fig. 1 ).

## 7. RECORD OF OBSERVATIONS

7.1 The observations should be recorded in the proforma given in Appendix A.

## 8. SOURCES OF ERROR

8.1 The sources of error like loose connections of reference studs/hooks and anchor rods, the perfect alignment of tape and instrument from lack of proper matching of points and reference holes, loose tensioning spring, etc, shall be guarded ( see Fig. 4 ).

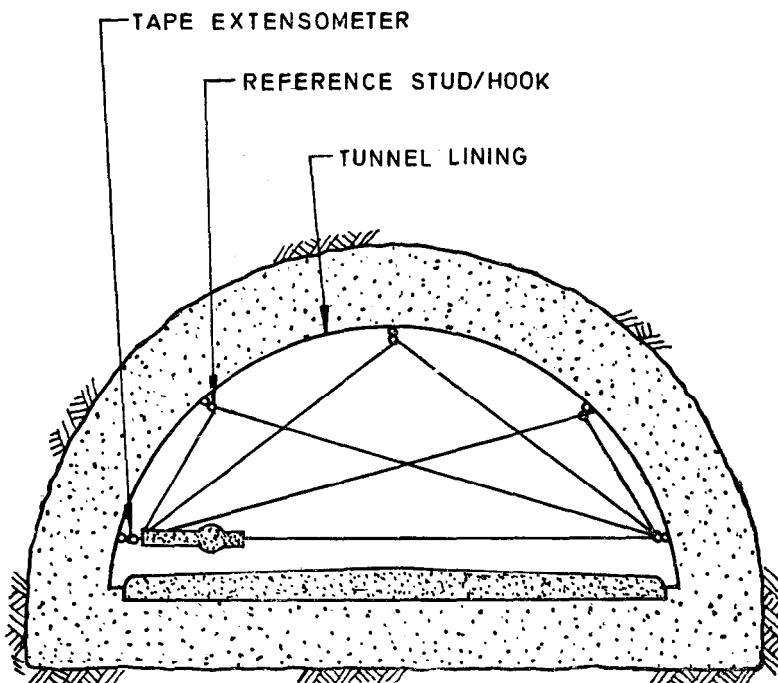

FIG. 3 PATTERN OF RADIAL GRID FOR MONITORING CONVERGENCE OF LINING

## 9. MAINTENANCE

9.1 The instrument should be kept clean. The tape should be lightly oiled. However, the spring plunger or tension screw should not be oiled as otherwise dirt would adhere to the instrument. The tension spring should be checked in the calibration frame (see Fig. 1B) for the fatigue which may occur in course of use. When the instrument is required to be dismantled for cleaning, its length should be checked with the help of portable calibration frame before dismantling and after reassembly so as to prevent alteration in its length.

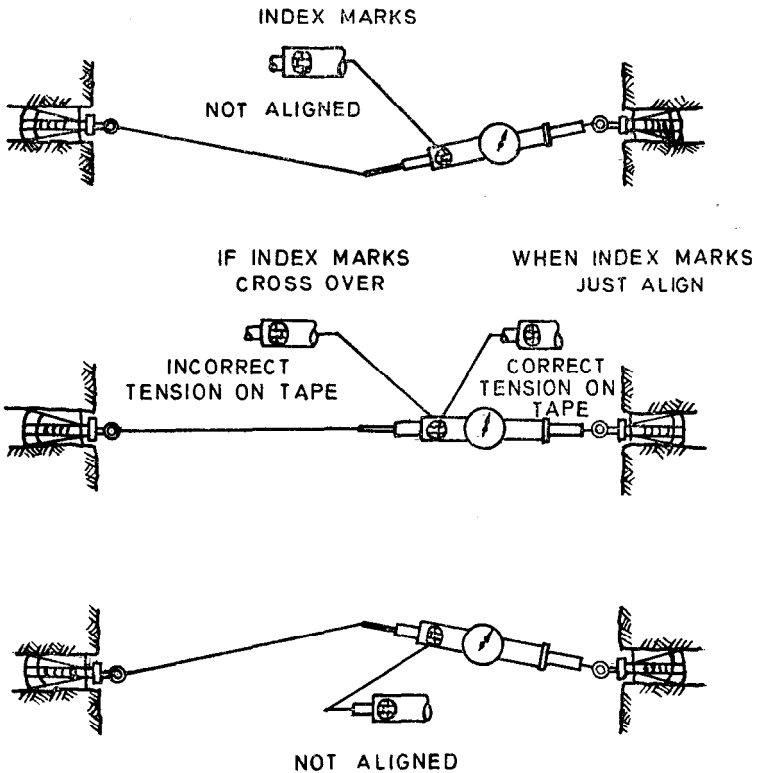

FIG. 4 ALIGNMENT PATTERN OF TAPE EXTENSOMETER

# APPENDIX A

( Clause 7.1 )

## PROFORMA FOR RECORD OF OBSERVATIONS OF TAPE EXTENSOMETER ( CONVERGENCE READINGS )

INSTRUMENT NO. ....

PROJECT .....

LOCATION .....

CORRECTION FACTOR  $k$  .....  
( Calibration result )

DATE OF INITIAL OBSERVATION...

DATE OF FINAL OBSERVATION .....

OBSERVATIONS BY .....

OBSERVATIONS BY .....

10

Sl No.	A <sub>1</sub>	C <sub>1</sub>	A <sub>2</sub>	C <sub>2</sub>	A <sub>1</sub> - C <sub>1</sub>	A <sub>2</sub> - C <sub>2</sub>	(A <sub>1</sub> -C <sub>1</sub> ) - (A <sub>2</sub> -C <sub>2</sub> )	Remarks
	Initial dial reading	Initial dial gauge reading	Final tape reading	Final dial guage reading	Initial distance between two reference studs	Final distance between two reference studs	Relative conver- gence or movement between two refe- rence studs under observation	

(Continued from page 2)

## Foundation Instrumentation Subcommittee, BDC 43 : 7

*Convener*

DR R. K. BHANDARI

*Representing*Central Building Research Institute (CSIR),  
Roorkee*Members*

SHRI K. N. BARTAR

SHRI M. IYENGAR

DR R. K. M. BHANDARI (*Alternate*)

SHRI Z. M. KARACHIWALA

DR B. V. K. LAVANIA

SHRI P. K. NAGARKAR

Pie Roorkee ( India ), Roorkee

Engineers India Ltd, New Delhi

Vasi Shums &amp; Co Pvt Ltd, Bombay

University of Roorkee, Roorkee

Maharashtra Engineering Research Institute,  
NasikSHRI M. K. KULKARNI (*Alternate*)

SHRI M. D. NAIR

Associated Instrument Manufacturers (I) Pvt Ltd,  
New DelhiSHRI A. V. SHASTRI (*Alternate*)

DR N. V. NAYAK

SHRI N. K. OZA

SHRI V. M. SHARMA

Asia Foundations &amp; Constructions Ltd, Bombay

Ministry of Railways, RDSO

Central Soil and Materials Research Station,  
New Delhi

PROF N. SOM

Jadavpur University, Calcutta

# INTERNATIONAL SYSTEM OF UNITS (SI UNITS)

## Base Units

<i>Quantity</i>	<i>Unit</i>	<i>Symbol</i>
Length	metre	m
Mass	kilogram	kg
Time	second	s
Electric current	ampere	A
Thermodynamic temperature	kelvin	K
Luminous intensity	candela	cd
Amount of substance	mole	mol

## Supplementary Units

<i>Quantity</i>	<i>Unit</i>	<i>Symbol</i>
Plane angle	radian	rad
Solid angle	steradian	sr

## Derived Units

<i>Quantity</i>	<i>Unit</i>	<i>Symbol</i>	<i>Definition</i>
Force	newton	N	1 N = 1 kg.m/s <sup>2</sup>
Energy	joule	J	1 J = 1 N.m
Power	watt	W	1 W = 1 J/s
Flux	weber	Wb	1 Wb = 1 V.s
Flux density	tesla	T	1 T = 1 Wb/m <sup>2</sup>
Frequency	hertz	Hz	1 Hz = 1 c/s (s <sup>-1</sup> )
Electric conductance	siemens	S	1 S = 1 A/V
Electromotive force	volt	V	1 V = 1 W/A
Pressure, stress	pascal	Pa	1 Pa = 1 N/m <sup>2</sup>